

Tract B is a piece of meadow situated in Weymouth Township and lays at the mouth of Stephens Creek on the West side of Egg Harbour River and is bounded as follows viz. Beginning at a stake at the mouth of Stephens Creek on the lower side and runs (1) N. 51° W. 7.50 (2) S. 88° W. 2.16 (3) S. 2.5° W. 1.63 (4) S. 14° W. 6.08 (5) S. 20° W. 4.24 (6) S. 62° E. 2.04 (7) S. 22° E. 2.00 (8) S. 15° E. 4.19 (9) S. 88° W. 2.70 (10) S. 38° E. 2.60 (11) S. 28° W. 3.00 (12) S. 88° E. 11.75 (13) N. 22° W. 13.00 (14) N. 5 1/2° W. 12.50 to the beginning containing 22 acres 5/100

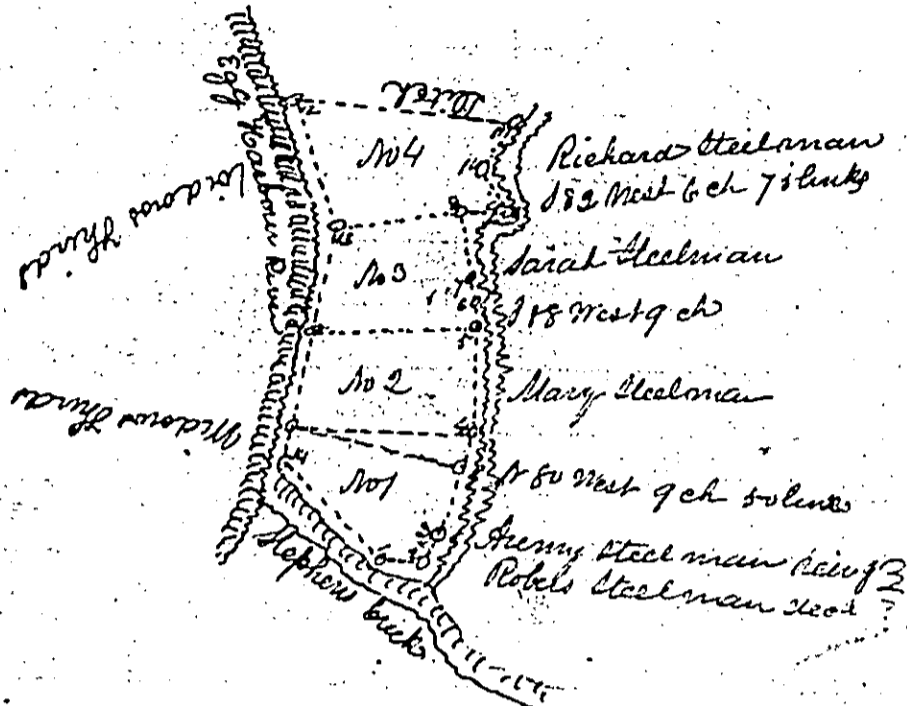

Protracted by a scale of 10 Degrees to the Inch  
 The share by us numbered one in dot A is described and bounded as follows: dot No 1 of tract A Beginning at a cedar tree standing in the sun it being a corner to land formerly belonging to Frederick Steelman dec'd and runs thence along his line North 7 degrees East 30 chains 75 links to a pine stump thence South 77 East 7 ch 49 links to a corner in the back line thence South 7 degrees W 31 chains to the South line thence North 77 West 7 chains 49 links to the Beginning dot No 3 of tract B Beginning at a corner standing by the side of a ditch a small creek and runs thence South 62 East 2 ch 4 links then South 22 East 2 chains then South 13 East 4 chains 19 links then North 82 East 6 chains 75 links to the River then binding the same North 5 1/2 West 5 chains 90 links to a stake thence South 88 W 9 chains to the beginning  
 Share No 2 in tract A begins at the fourth corner of dot No 1 and runs thence along the line of the said dot North 7 East 30 chains to the back line thence along the back line 177 East 7 ch 49 links to a stake thence South 7 degrees West 19 ch 25 links to a stake thence 77 East one chain then 7 degrees West one chain thence South 77 West one chain along the middle of the road in front of the house thence South 7 degrees West 10 chains 90 links to the South line thence along the same South 77 West 7 ch 49 links to the Beginning  
 Share No 3 in tract A begins at the fourth corner of dot No 2 and runs thence along the line of dot No 3 to the back line and thence along the said line South 77 East 7 ch 49 links to a stake thence S 6 West 31 chains 80 links to the South line thence along the same to the Beginning  
 Lot No 2 in tract B begins at the beginning corner of dot No 3 of said tract and runs North 88 East 9 chains to the River thence binding the same N 5 1/2 West 5 chains 90 links to a stake thence N 80 West 9 chains 50 links to a small creek thence binding the same to the place of Beginning  
 Share No 4 of tract A begins at the fourth corner of dot No 3 and runs thence along the line of said dot to the back line thence along the same South 77 East 7 chains 49 links to a stake thence 17 West 31 chains 46 links to the South line thence along the same to the Beginning dot No 1 of tract B begins at the mouth of Stephens Creek at a stake and runs up said creek N 57 West 7 ch 50 links thence S 88 W 2 chains 16 links thence S 26 West 1 ch 63 links thence binding a small creek to the corner of dot No 2 thence along the line of said dot S 80 East 9 ch 50 links to the River thence N 6 1/2 W along the River to the place of Beginning  
 Lot No 3 of tract A begins at a pine stump it being the Beginning corner of the said tract and runs from thence S 77 West 10 chains 9 links to the fourth corner of dot No 4 and runs thence along the line of said dot to the back line thence S 7 East 7 ch 49 links to the fourth corner of the said tract thence S 11 West 6 chains 50 links to the beginning

begins at the mouth of a small ditch that enters into the River at the South East corner of the said tract and runs along the river North 22 West bounding the same 7 chains 21 links to the corner of dot No 3 then along the line of dot No 3 South 82 West 6 chains 75 links to a small creek thence along the said creek the several courses to a small ditch thence down the said ditch 188 West 11 ch 75 links to the Beginning

We certify the foregoing to be the Map and field Book in the case above said  
 Witness our hands and seals this fourteenth day of May eighteen hundred and fifty

John C. Abbott  
 Seal  
 Seal  
 Seal

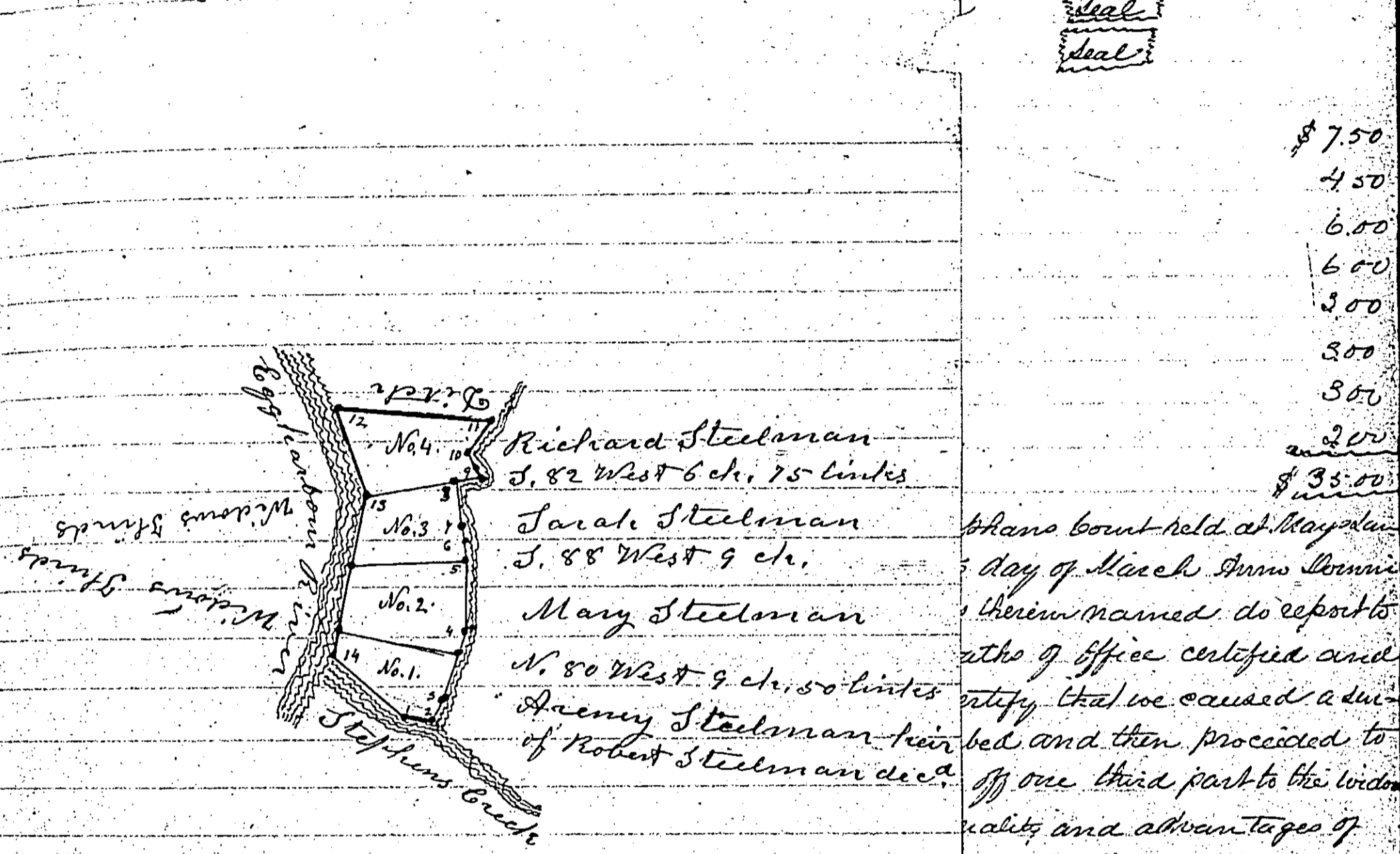

Protracted by a scale of 10 Degrees to the Inch  
 Tract B is a piece of meadow situated in Weymouth Township and lays at the mouth of Stephens Creek on the West side of Egg Harbour River and is bounded as follows viz. Beginning at a stake at the mouth of Stephens Creek on the lower side and runs (1) N. 51° W. 7.50 (2) S. 88° W. 2.16 (3) S. 2.5° W. 1.63 (4) S. 14° W. 6.08 (5) S. 20° W. 4.24 (6) S. 62° E. 2.04 (7) S. 22° E. 2.00 (8) S. 15° E. 4.19 (9) S. 88° W. 2.70 (10) S. 38° E. 2.60 (11) S. 28° W. 3.00 (12) S. 88° E. 11.75 (13) N. 22° W. 13.00 (14) N. 5 1/2° W. 12.50 to the beginning containing 22 acres 5/100

Witness our hands and seals this 14th day of May eighteen hundred and fifty

John C. Abbott  
 Seal  
 Seal  
 Seal

\$ 7.50  
 4.50  
 6.00  
 6.00  
 3.00  
 3.00  
 3.00  
 2.00  
 \$ 35.00

Share bought held at May day of March Annus Domini therein named do report to the office certified and certify that we caused a survey of one third part to be taken and then proceeded to divide and then proceeded to divide and then proceeded to divide as nearly as may be and in shares that they would share progressively to himself and made a true and also maps of the tract here and thereupon we gave equal as possible whereupon the by us such share as would be divided among themselves we have widow to have her share in tract B we set off to John Steelman at Steelman dot No 3 in tract man heir of Robert Steelman to Richard Steelman dot No 4 in tract A also dot No 4 of tract B and we do annex hereto the map and field books above showing the respective shares aforesaid

Witness our hands and seals this 14th day of May eighteen hundred and fifty  
 John C. Abbott  
 Seal  
 Seal  
 Seal